

Assured Success

by

INNOVATION

QUALITY

EXPERTISE



The background of the entire page is a photograph of the interior of a large agricultural dome. The structure is made of a complex metal framework with a translucent covering. Rows of plants are growing in white fabric bags, which are arranged on a raised bed system. The plants are small and green, and the overall environment appears clean and well-maintained.

AgroDome is one of the leading name in the CEA/PC (controlled Environment Agriculture/ protected Cultivation) with over 14 years of experience since 2010 in delivering innovative and sustainable solutions. We specialize in designing , manufacturing and implementing High - Tech Agriculture projects across the globe.

With a strong portfolio of 500+ successfully completed projects covering more than 7 million square meters, AgroDome has redefined agriculture efficiency and productivity . Our expertise spans across 17+ countries offering 40+ unique, innovative and customized designs to meet the customers special needs.

At AgroDome , we are committed to advancing CEA /PC Technology , ensuring optimal growing environments and enhancing the overall agriculture efficiency for a sustained future .



1

INNOVATIVE SOLUTION:

Understanding each clients unique needs, we provide customized solutions for optimal results in agricultural projects.



2

PROFESSIONAL SUPERVISION:

Our commitment to overseeing every projects aspects and ensure success from inception to completion, setting us apart with unwavering commitment, excellence and reliability



3

RICH EXPERIENCE

With close to one and a half decade's experience, We have team's for domestic and global operations, Playing role in success of projects.



HIGH PERFORMANCE

Our project implement excellence & services boosts crop yields and overall agriculture efficiency.



QUALITY MATERIAL

Based on principal of quality in- quality- out ,we use high quality materials and construction method that contribute to the durability and longevity of the greenhouse structure.



INTEGRITY



ACCOUNTABILITY



COMITMENT



CUSTOMER FOCUS



TEAM WORK



500 +
Projects

14 +
Years of
Experience Since
2010

17 +
Countries

7 MILLION +
sq. Mtr.
Area

40 +
innovative
structure

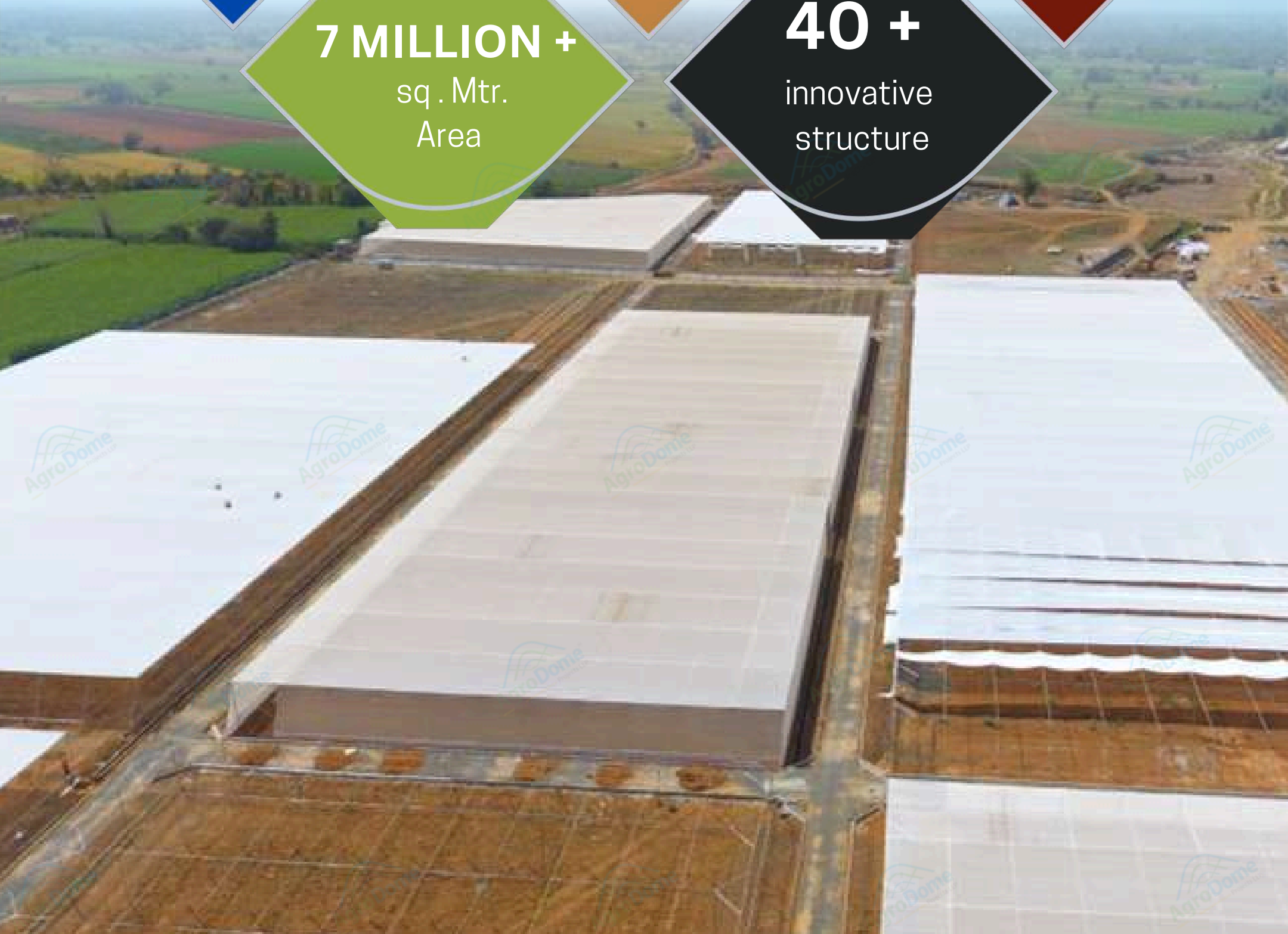

Our PMC Scope and Turnkey Service (Project Management & Consulting)

Understanding Project Goals

- ▶ **Products (Crops):**
What needs to be grown
- ▶ **Market:**
Where the produces are intended to be sold
- ▶ **Financial:**
What's the budget & What's the ROI expectations
- ▶ **Location:**
Where the project is to be executed
- ▶ **Gap Analysis:**
Soil (Growing Media), Water, Climate
- ▶ **Setting Right the Expectations & Outcomes**

Designing the Project

- ▶ **Location Finding**
- ▶ **Site Survey**
 - Soil analysis
 - Water analysis
 - Climate control analysis
 - Logistics analysis
 - Manpower feasibility
 - Ease of management feasibility
- ▶ **Layout and Planning**
 - Growing areas (Open field, Covered)
 - Internal & external roads
 - Water source, storage & drainage
 - Power (Electricity, Solar)
 - Irrigation
 - Storage (Warehouse, Cold Storage)
 - Packing & Grading
 - Farm produce movement
 - Processing & Packaging
 - Machineries / Facility
 - Weather Station
 - Admin Building
 - Workers' Colony
 - Sanitation
 - Vehicles & Parking
 - Fencing & External boundary
- ▶ **Feasibility Study / DPR**
(Detailed Project Report)

Project Execution

- ▶ **Land Leveling & Civil Works / Construction**
 - Fencing, Roads, Buildings, Electricals, Facilities, etc.
- ▶ **Construction of PC & CEA Structures**
 - Greenhouses, Polyhouses, Glasshouses (Design, Procure, Build, Transfer)
- ▶ **Irrigation**
 - Main water line, borewell, head/tank, pumps, pipeline, filtration, fertigation mixing unit, automation
- ▶ **Automation & Climate Control**
 - Weather data collection, Sensors, Motors, Fertigation, Shading, Ventilation, Heating, Cooling
- ▶ **Growing Media**
 - Bed Preparation, Soil & its treatment, Growbags, Cocopeat, Perlite, Vermiculite, Blocks, Slabs, NFT, Hydroponics, etc.
 - Growing Bags, Troughs & Trenches
- ▶ **Planting Material**
 - Seeds, Cuttings, Drafting, Seedling Transplantation
- ▶ **Manpower & SOPs**
 - Pre & Post Harvest GFCI organization
 - Manpower Plan, JDs & KRIs (Job Descriptions & Key Responsibility Areas)
 - KRA (Key Result Areas), KPI (Key Performance Indicators)
 - Hiring & Training



Multi Span Tunnel



Dome Roof Net House -DRNH



Naturally Ventilated Poly House - NVPH



Wire Rope House (Nursery)



Single Span Tunnel



Wire Rope Net House (WRNH)



Pear Orchard Structure



Pomegranate Orchard Structure



Dome Roof Poly Net House -DRPNH



Single Span NVPH



Fan Pad Polyhouse - FPPH



Solar Dryer Structure



Wire Rope Polyhouse



Apple Orchard Structure



Grapes Orchard Sliding Structure



Cherry Orchard Sliding Structure



Dragon Fruits Orchard Structure



Flat Roof Net House



Single Span Fan Pad Green House



Poly Carbonate Structure

Naturally Ventilated POLY HOUSE - NVPH

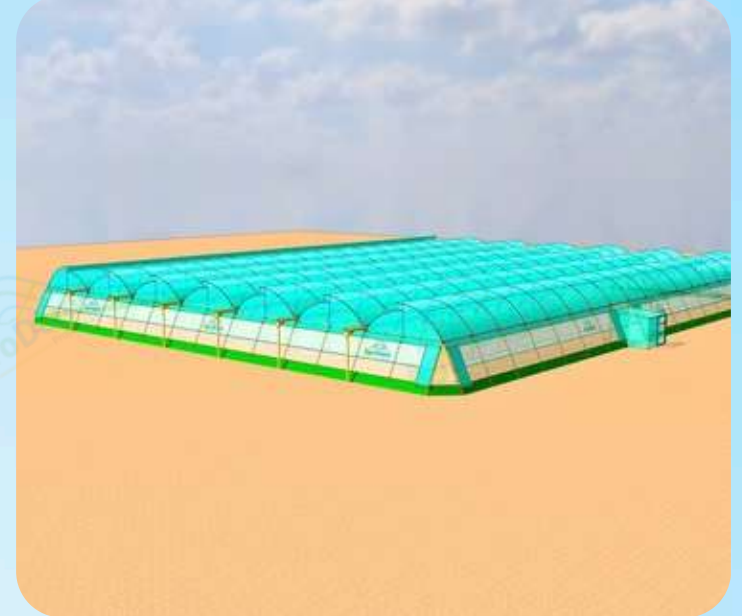

- Most Suitable for Tropical & Heavy Rain Fall Regions.
- This Structure is Suitable for the Cultivation of Flowers and Vegetables.
- It Provides Good Micro / Climate Control Systems.
- It Has High Wind Resistance and Crop Load Bearing Capacity.



TECHNICAL SPECIFICATION

• Grid	8 m X 4 m , 12 m x 4 m , 9.6 m X 4 m , 8 m X 3 m
• Side /Center height	3 m /5.5 m , 4 m /2.5 m , 4.5 m /7 m , 5 m /7.5 m, 5.5 m / 8 m
• Side corridors	1.5 m, 2 m , 2.5 m, 3 m
• Top covering	0.800 to 0.1 5/7 layer smart UVS Polyethylene Films
• Side ventilation	Insect net, Skirting Fabric
• Irrigation	Fogging system , Sprinkler system, Inline irrigation , Online irrigation system
• Crop support	Trellising system

MULTI SPAN HIGH TUNNEL

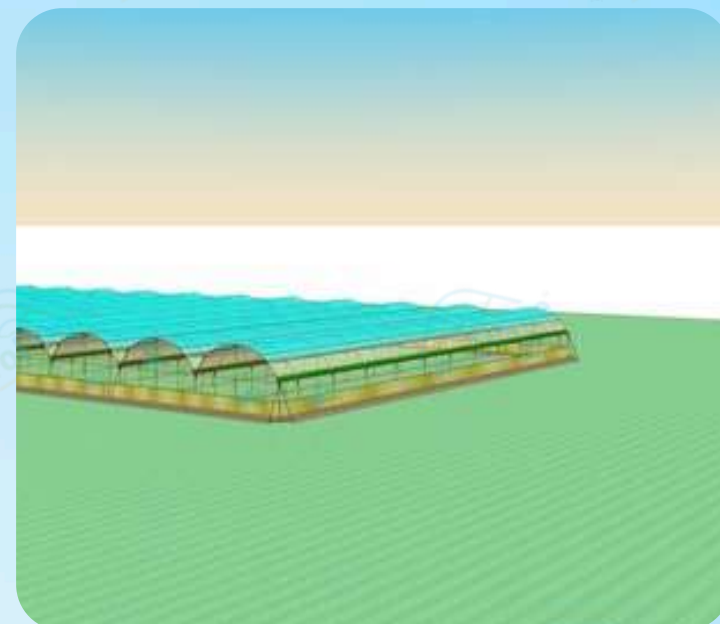

- Suitable for Flowers, Exotic Vegetables Viz. Broccoli, Cherry Tomato and Leafy Green Viz. Spinach, Mustard Green.
- Controls Temperature, Sunlight and Humidity
- Capable of Withstanding Harsh Weather Conditions.
- Very Much Economical Option for Covering a Large Areas.



TECHNICAL SPECIFICATION

• Grid	7.2 m x 4 m , 6 m x 4 m , 9.6 m x 4 m , 7.2 m x 3 m , 9.6 m x 3 m
• Side /Center height	2 m /2.5 m , 2.5 m /2 m , 2.5 m /2.5 m
• Side corridors	1.5 m, 2 m , 2.5 m, 3 m
• Top covering	Poly film and Shad net , Bird net
• Side ventilation	Insect net, Bird net
• Irrigation	Fogging system ,Inline irrigation , Online irrigation system
• Crop support	Trellising system

Wire Rope - Cable Rope FLAT ROOF NET HOUSE

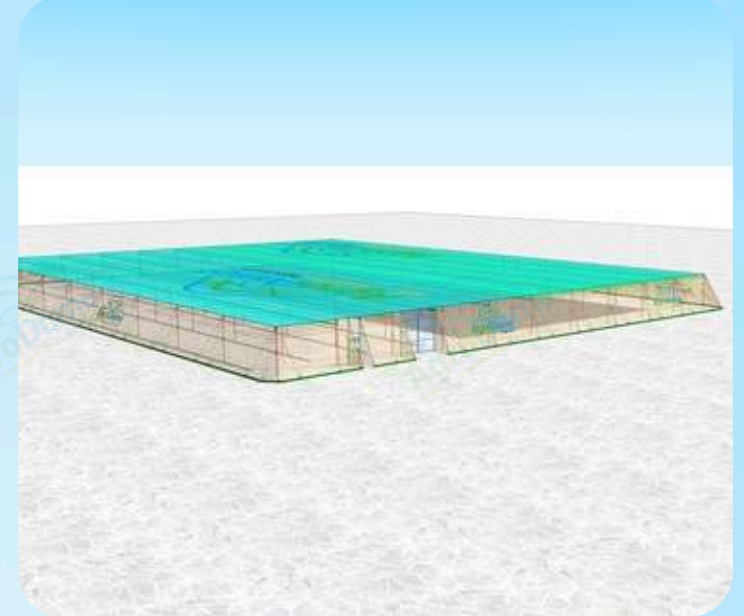

- Suitable for Cultivating Vegetables, Fruits, Raising and Hardening Nursery or Tissue Culture Plants.
- "Highly suitable for perennial crops like banana."
- Suitable for High-yield Production in Hot and Dry Weather Conditions.
- A Highly Economical Option for Covering Large Areas.



TECHNICAL SPECIFICATION

• Grid	8 m x 6 m ,10 m x 6 m ,8 m x 5 m ,12 m x 6 m
• Side /Center height	3 m ,4 m ,5 m ,6 m
• Side corridors	1.5 m, 2 m , 2.5 m, 3 m
• Top covering	Insect Net , Shade Net
• Side ventilation	Insect Net , Shade Net
• Irrigation	Fogging system ,Inline irrigation , Online irrigation system
• Crop support	Trellising system

Flat Roof NET HOUSE

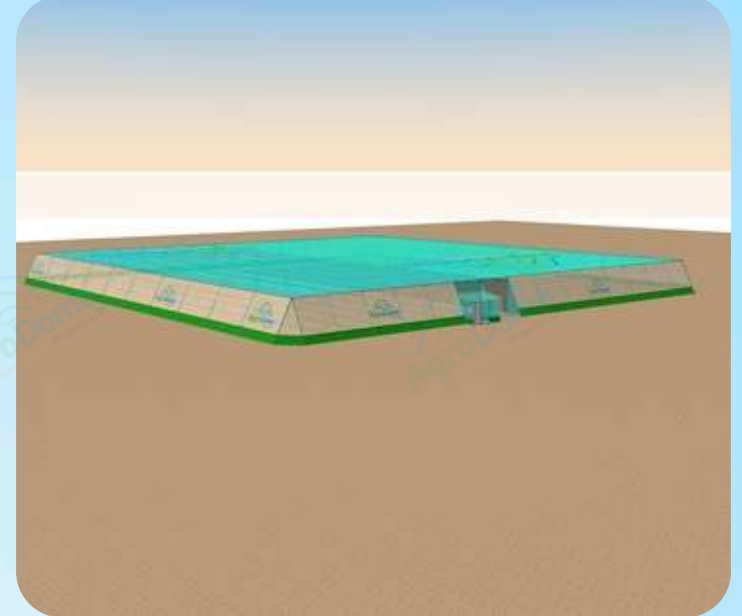

- Suitable for Cultivating Vegetables, Fruits, Raising and Hardening Nursery or Tissue Culture Plants.
- Control of Temperature , Sunlight and Humidity.
- Strong Capacity to Withstand Harsh Weather Conditions.
- Economical Options for Covering Large Areas.



TECHANICAL SPECIFICATION

• Grid	6 m X 4 m , 4 m X 4 m , 6 m X 6m
• Side /Center height	3m , 4 m , 5 m , 6 m
• Side corridorr	1.5m , 2 m , 2.5 m , 3 m
• Top covering	125 GSM Mono X Mono Net
• Side ventilation	Insect Net - 40 GSM , 110 GSM / Apron 160 Fabric GSM
• Irrigation	Fogging system ,Inline irrigation , Online irrigation system ,Sprinkler system
• Crop support	Trellising system

Wire Rope Net House

NURSERY

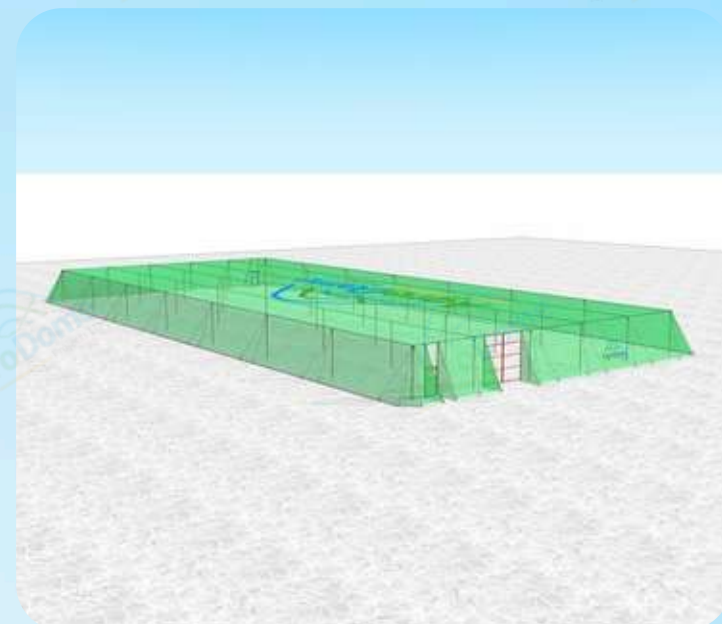

- Suitable for Tissue Culture Plant Hardening and Vegetable Crops.
- Control of Temperature and Sunlight.
- Capable of Withstanding Harsh Weather Conditions.
- Economical Options for Covering Large Areas.



TECHNICAL SPECIFICATION

• Grid	8 m x 6 m , 10 m x 6 m , 8 m x 5 m , 12 m x 6 m
• Side /Center height	3 m , 4 m
• Side corridors	1.5 m , 2 m , 3 m
• Top covering	Insect Net , Shade Net
• Side ventilation	Insect Net , Shade Net
• Irrigation	Sprinkler system , fogging system
• Crop support	Trellising system

Wire Rope Polyhouse

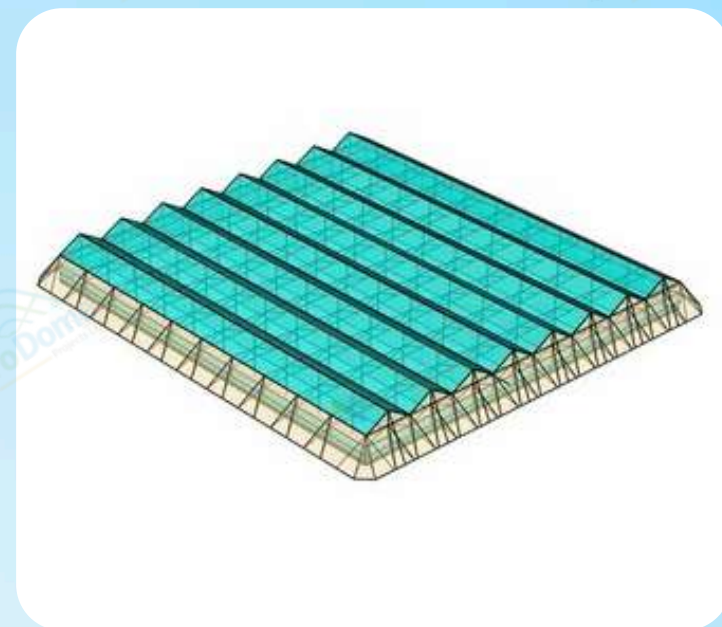

- Suitable for Flower Cultivation, Vegetables and Cherry Cannabis.
- Control of Temperature, Sunlight, and Humidity. Suitable for Regions With High Rainfall.
- Protection Against Pests, Frost, Heavy Rainfall, and Harsh Weather.
- Affordable Options for Covering Large Areas.



TECHNICAL SPECIFICATION

• Grid	7 m X 6 m , 6 m X 4 m , 6 m X 4 m
• Side /Center height	3 m / 5m , 4 m / 6m
• Side corridors	2 m
• Top covering	Woven Laminated UVS Skirting Fabric ,Rain protect Net
• Side ventilation	Insect net ,Shade net ,Bird net
• Irrigation	Fogging system ,Inline irrigation , Online irrigation system ,Sprinkler system
• Crop support	Trellising system

Dome Roof Net House

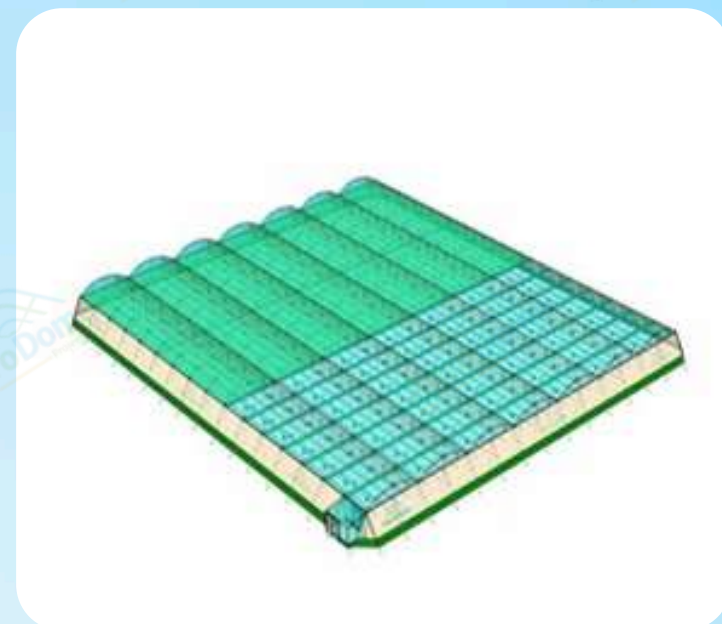

- Suitable for Various Vegetables and Some Flowers.
- Best Structure for Floriculture, Nursery, and Hardening of Crops Like Tomato, Capsicum, Papaya, and Banana.
- Protects Crops From Wind, Hot Weather, Insects, Pests, and Diseases.
- Economical options for covering large areas.



TECHNICAL SPECIFICATION

• Grid	6 m X 4 m , 8 m X 4 m
• Side /Center height	4 m / 1.5 m , 3 m / 5 m , 4.5 m / 6 m
• Side corridors	1.5 m , 2 m , 2.5 m
• Top covering	5/7 Layer Smart UVS Polyethylene
• Side ventilation	Insect net , Shade net , Bird net
• Irrigation	Fogging system , Inline irrigation , Online irrigation system , Sprinkler system
• Crop support	Trellising system

Dome Roof Poly Net House

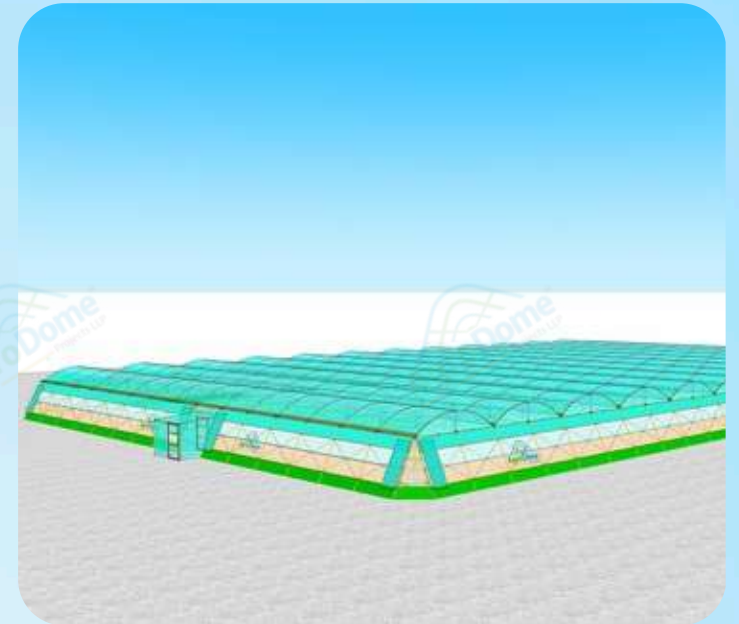

- Suitable for Tissue Culture Labs, Exotic Vegetables and Leafy Greens.
- Maintains an Environment With High Ventilation During Rainy and Humid Days.
- Strong Capacity to Withstand Harsh Weather Conditions.
- Economical Options for Covering Large Areas.



TECHNICAL SPECIFICATION

• Grid	6 m X 4 m , 8 m X 4 m , 8 m X 3 m , 6 m X 3m
• Side /Center height	4 m / 1.5 m , 3 m / 1.5 m , 4.5 m / 1.5 m
• Side corridors	1.5m , 2 m , 2.5 m
• Top covering	5/7 Layer Smart UVS Polyethylene , Shade net
• Side ventilation	Insect net , Poly films , Apron Fogging system ,Inline irrigation , Online irrigation system ,Sprinkler system
• Irrigation	
• Crop support	Trellising system

Fan Pad Green House



- Suitable for Tissue Culture Labs, Exotic Vegetables and Greens, Microgreens, Mushrooms, and Hydroponic Farming.
- The Internal Climate Can Be Controlled as Per Requirements.
- Suitable for Regions With Extreme Weather Conditions. Allows for a
- Second-layer Sliding Roof for Optimum Control of Inner Climate.



TECHNICAL SPECIFICATION

• Grid	8 m X 4 m , 8 m X 3 m , 10 m X 4m
• Side /Center height	3 m / 5 m , 4 m / 5.5 m , 4.5 m / 6 m
• Side corridors	1.5 m , 2 m , 2.5 m
• Top covering	5/7 layer UVS Polyethylene films
• Side ventilation	6 mm /10 mm UVS Twin wall Polycarbonate sheet , Poly film , Insect net , Skirting fabric Fogging system ,Inline irrigation , Online irrigation system ,Sprinkler system
• Irrigation	
• Crop support	Trellising system

Polycarbonate Structure

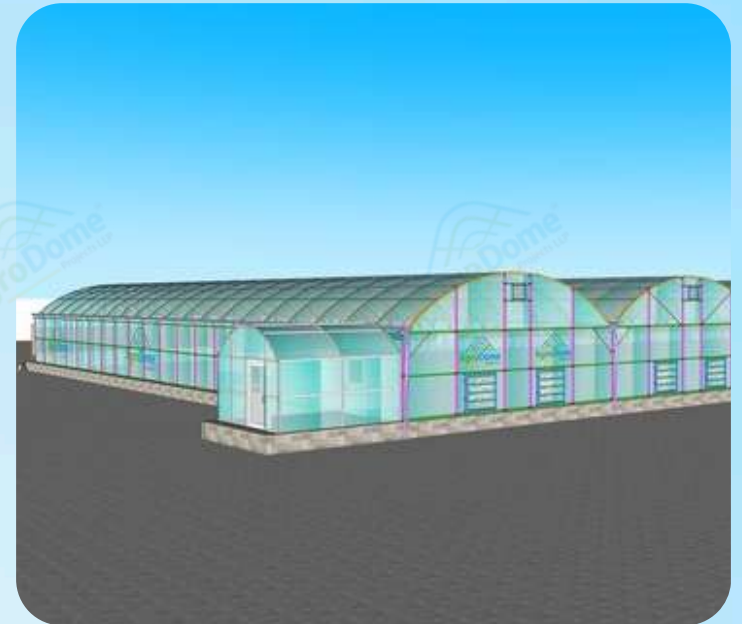

- Suitable for Exotic Vegetables, Leafy Greens and Fruits.
- Best Suited for Regions With Extreme High Temperatures.
- Protects Crops From Diseases, Pests, Extreme Heat and Harmful UV Rays.
- It Provides an Extended Growing Season.



TECHNICAL SPECIFICATION

• Grid	8 m X 2.1 m , 6 m X 2.1 m , 9.6 m X 2.1 m , 7 m X 2.1 m
• Side /Center height	2.5 m / 4.5 m , 3 m / 5 m , 4 m / 6 m , 4 m / 5.5 m
• Side corridors	3 m , 2 m
• Top covering	4 mm / 6 mm / 8 mm by Polycarbonate sheet
• Side ventilation	4 mm / 6 mm / 8 mm by Polycarbonate sheet
• Irrigation	Fogging system ,Inline irrigation , Online irrigation system ,Sprinkler system
• Crop support	Trellising system

Single Span Tunnel



- Suitable for Low-height and Leafy Vegetables, and Flowers Like Bera , Chrysanthemum and Gladiolus.
- Suitable for Hilly, Mountainous, Snowy and Cold Climate Areas.
- Maintains Steady and Good Microbial Climate, Protects Crops For Harsh Weather Conditions.
- Economical Options for Covering Small Areas.



TECHNICAL SPECIFICATION

• Grid	6 m X 4 m , 4 m X 4 m ,6 m X 6m
• Side /Center height	3m , 4 m , 5 m , 6 m
• Side corridors	1.5m, 2 m , 2.5 m , 3 m
• Top covering	5/7 Layer Smart UVS Polyethylene films , Skirting fabric with insect net, Rain Protections net
• Side ventilation	Poly films , Insect net , Shade net, Bird net
• Irrigation	Fogging system , Inline irrigation , Online irrigation system , Sprinkler system
• Crop support	Trellising system

Single Span Naturally Ventilation Poly House



- Suitable for Flower , Cultivation of Exotic Vegetable & Leafy Greens.
- Control of Temperature , Sunlight and Humidity.
- Capable of Withstanding Harsh Weather Conditions.
- Economical Options for Covering Large Areas.



TECHNICAL SPECIFICATION

• Grid	6 m x 4 m , 8 m x 4 m , 6 m x 3m , 8 m x 3 m , 10 m x 4 m
• Side /Center height	2.5 m / 2.5 m , 3 m / 2.5 m , 4 m / 2.5 m
• Side corridors	1 m , 2 m , 2.5 m
• Top covering	5/7 layer smart UVS Polyethylene films
• Side ventilation	5/7 Layer smart UVS Polyethylene films
• Irrigation	Fogging system ,Inline irrigation , Online irrigation system ,Sprinkler system
• Crop support	Trellising system

Solar Dryer Structure



- Suitable for Drying Fruits, Vegetables, Spices, Pulses, Grains, Fish, Etc.
- Protects Products From Dust, Insects and Rain.
- Economical Options for Reducing Post-harvest Losses.
- Sustainable, Eco-friendly Drying Methods With Low Operational Cost.



TECHNICAL SPECIFICATION

• Grid	6 m x 4 m , 6 m x 3 m , 8 m x 4 m , 5 m x 3 m
• Side /Center height	4 m / 2 m , 3 m / 2 m
• Side corridors	As per requirement
• Top covering	5/7 Layer smart UVS Polyethylene films (200 micron clear)
• Side ventilation	5/7 Layer smart UVS Polyethylene films (200 micron clear) ,apron
• Irrigation	Not applicable
• Crop support	Not applicable

Single Span FAN PAD GREEN HOUSE



- Suitable for Flower , Cultivation of Exotic Vegetable & Leafy Greens.
- Control of Temperature , Sunlight and Humidity.
- Strong Capacity to Withstand Harsh Weather Conditions.
- Economical Options for Covering Small Areas.



TECHNICAL SPECIFICATION

• Grid	6 m x 4 m , 6 m x 3 m , 8 m x 4 m , 5 m x 3 m , 8 m x 3 m
• Side /Center height	4 m /1.7 m , 3 m /1.7 m , 2.5 m /1.7 m , 3.5 m /1.7 m
• Side corridors	1 m , 1.5 m , 2 m
• Top covering	5/7 Layer smart UVS Polyethylene films & Shade net
• Side ventilation	5/7 Layer smart UVS Polyethylene films , apron fabric
• Irrigation	Fogging system , Inline irrigation , Online irrigation system , Sprinkler system
• Crop support	Trellising system

Pear Orchard Structure

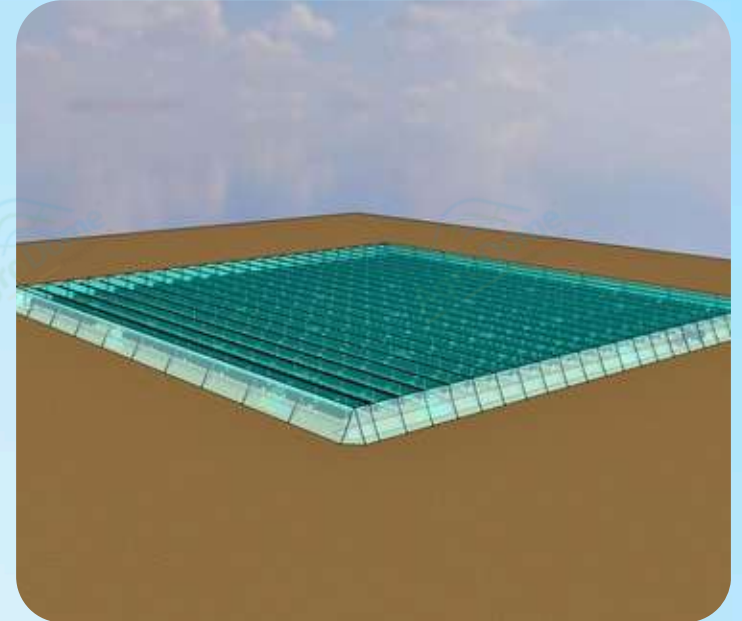

- Specially Designed Structure for Pear and Cherry Cultivation.
- Control Temperature, Sunlight, Humidity, and Provides Protection From Hailstorms.
- Increased Yield, High-quality Produce, and Year-round Production.



TECHNICAL SPECIFICATION

• Grid	4 m x 8 m , 4 m x 10 m , 3 m x 8 m , As per Planation
• Side /Center height	4 m
• Side corridorrs	2 m
• Top covering	Poly film , Shade net , Anti hail net , Apron sheet
• Side ventilation	Bird net , Insect net
• Irrigation	Orchard Irrigation
• Crop support	As per Plant requirement

Apple Orchard Structure

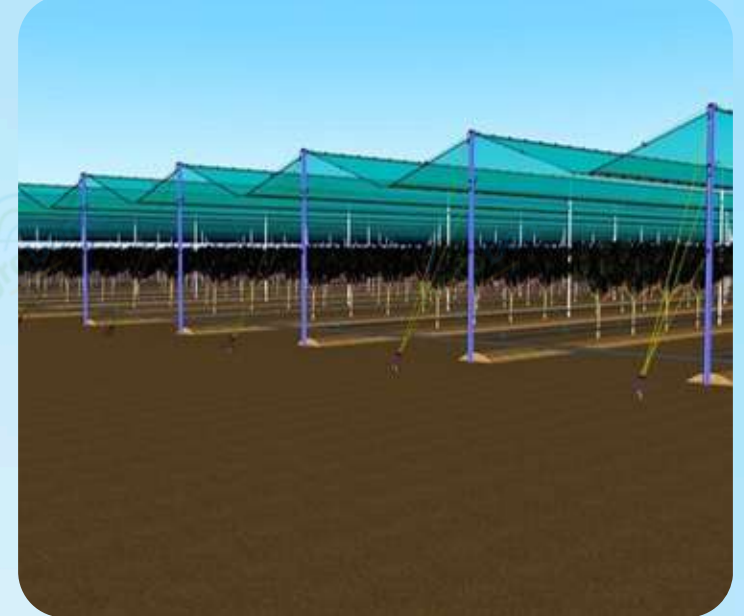

- Specially Designed Structure for Hail-prone Apple Orchard Regions.
- Effectively Controls Temperature, Sunlight and Humidity, While Providing Protection From Hailstorms.
- Capable of Withstanding Heavy Crop Load.
- Ideal for High-density Apple Cultivation.



TECHNICAL SPECIFICATION

• Grid	4 m x 8 m , 4 m x 10 m , 3 m x 8 m , As per Planation
• Side /Center height	4 m
• Side corridorr	2 m
• Top covering	Poly film , Shade net , Anti hail net , Apron sheet
• Side ventilation	Bird net , Insect net
• Irrigation	Orchard Irrigation
• Crop support	As per Plant requirement

Grapes Orchard Structure

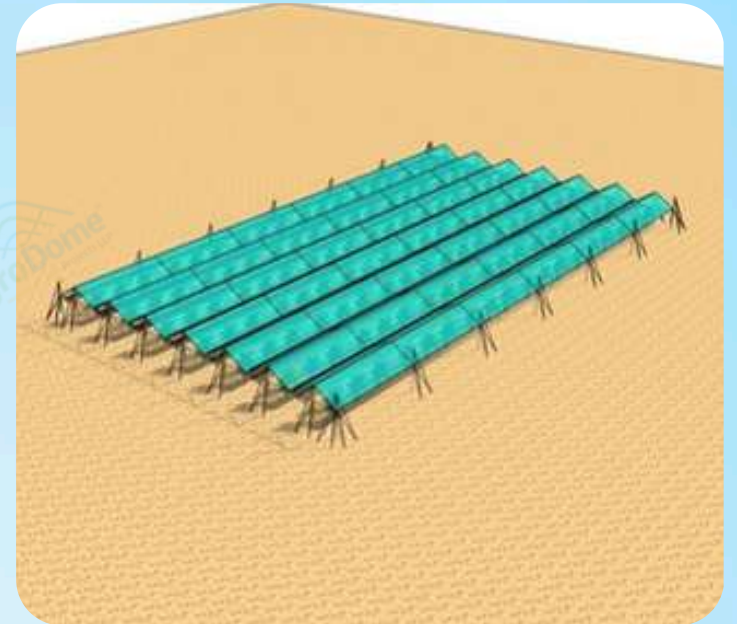

- Specially Designed for Grapes and Cherry Crop.
- Protects Crops From Wind, Frost, Rain, Snow and Disease.
- Customised Sliding Available, Allowing Even Distribution of Light for Efficient Plant Growth.
- Availability During the Off-Season Period.



TECHNICAL SPECIFICATION

• Grid	3 m x 6 m ,As per Plantation
• Side /Center height	2 m / 4 m , 2.5 m / 4 m
• Side corridors	2 m
• Top covering	Apron fabric , Hail net , Poly film
• Side ventilation	Bird net
• Irrigation	Orchard Irrigation
• Crop support	As Per Crop Requirement

Cherry Orchard Structure

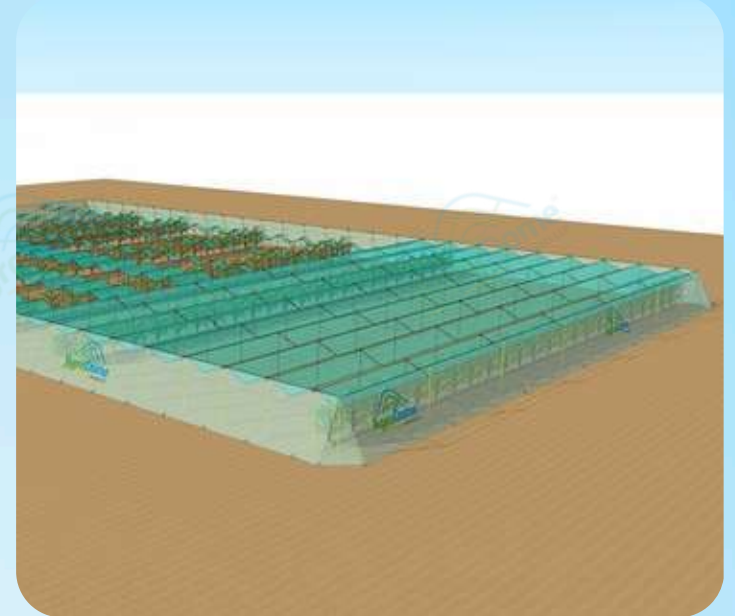

- Specially Designed for Grapes and Cherry Crop.
- Protects Crops From Wind, Frost, Rain, Snow and Disease.
- Customised Sliding Available, Allowing Even Distribution of Light for Efficient Plant Growth.
- Availability During the Off-Season Period.



TECHNICAL SPECIFICATION

• Grid	4 m x 8 m , 4 m x 10 m , 3 m x 8 m , As per Planation
• Side /Center height	4 m
• Side corridorrs	2 m
• Top covering	Poly film , Shade net , Anti hail net , Apron sheet
• Side ventilation	Bird net ,Insect net
• Irrigation	Orchard Irrigation
• Crop support	As per Plant requirement

Dragon Fruit Orchard Structure

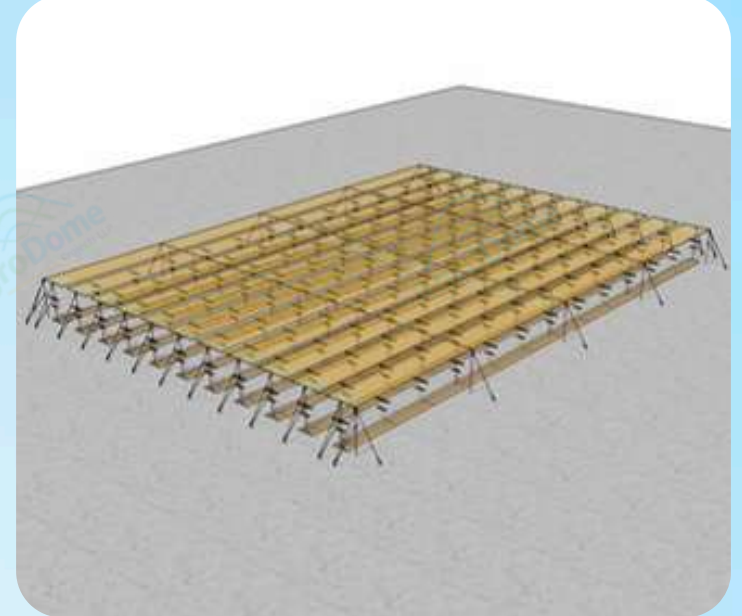

- Protects Fruits Against Wind, Rain Damage and Scorching Sunlight.
- Increases Planting Density, Crop Yield and Space Optimization.
- Vertical Support System Improves Flowering and Enhances Fruit Quality.



TECHNICAL SPECIFICATION

• Grid	As per plantation requirement
• Side /Center height	5.5 m
• Side corridors	2 m
• Top covering	Poly film
• Side ventilation	-
• Irrigation	As per Plantation
• Crop support	Customizable As per crop requirement

Pomegranate Orchard Structure

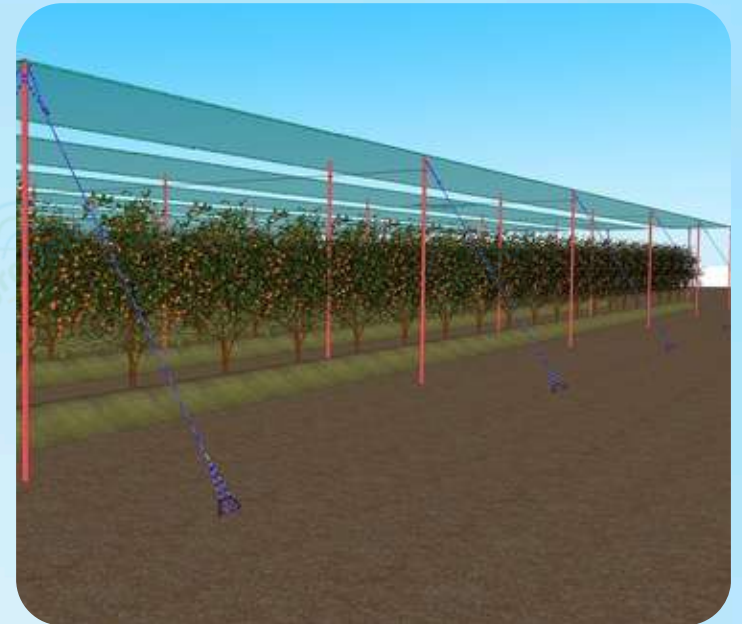

- Extends the Fruiting Season While Maintaining High Fruit Quality.
- Customizations Can Be Done Including Height and Row Spacing.
- Specially Designed for Pomegranate Orchard Structures.
- Protects Fruits From Excessive Sunlight and Rain, Reducing Cracking and Improving Fruit Quality.



TECHNICAL SPECIFICATION

• Grid	12 feet x 6 m , 12 feet x 8 m , 24 feet x 8 m
• Side /Center height	4 m , 5 m
• Side corridors	2 m
• Top covering	Shade net , Anti hail net
• Side ventilation	-
• Irrigation	As per requirement
• Crop support	As per crop requirement

Sludge Drying Structure

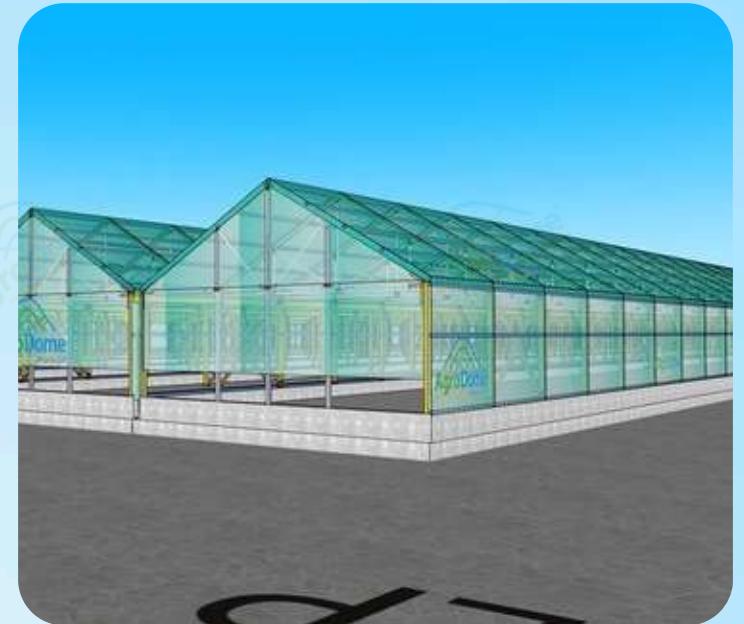

- To dewater sludge generated from primary or secondary wastewater treatment through natural drying reducing volume for easier handling and disposal.
- The Sludge Drying Structure offers an energy-efficient, eco-friendly solution for reducing sludge moisture and volume, using solar or air drying for easy, cost-effective disposal.



TECHNICAL SPECIFICATION

• Grid	12 m x 2.5 m , 10 m x 2.5 m , 7 m x 2.5 m
• Side /Center height	4.5 m / 6m, 4m / 6m
• Side corridors	Depend on location and climate conditions
• Top covering	6 mm Polycarbonate 2 Layer sheet - 2 mm polycarbonate single layer sheet
• Side covering	6 mm Polycarbonate 2 Layer sheet - 2 mm polycarbonate single layer sheet
• Sludge movement system	Motorized sludge movement system or Robot for sludge movement
• Fan system	Air circulation fan and heat generator fan

• Type of growing media for soilless farming

Coco Chips	Cocopeat Bricks/Blocks	Coco perlite	coco fiber
			
USAGE CROP	USAGE CROP	USAGE CROP	USAGE CROP
<ul style="list-style-type: none">• orchids• succulents• cacti• other plants	<ul style="list-style-type: none">• vegetables• fruits• flowers• herbs	<ul style="list-style-type: none">• container gardening• hydroponics	<ul style="list-style-type: none">• Lettuce & Leafy Greens• Capsicum (Bell Pepper)• Cucumber

WHY CHOOSE FOR FARMING

- Coco peat can hold 8 to 10 times its weight in water, ensuring constant moisture to the plant roots. creates superior aeration due to its fibrous and spongy structure. Prevents roots rot.
- Due to its ideal PH contents ranging between 5.5 to 6.8 ideally suitable for plantations.
- coco pet suits wide range of plants as no PH adjustment is required.
- Being naturally resistant to harmful pathogens and relatively sterile, Coco pet lowers the risk of soil born diseases..

Greenhouse Irrigation Systems – Specifications

1 Drip Irrigation

- WaterUse: 2–8 LPH per emitter
- Pressure: 2–3.5 kg/cm²
- Pipe Size: 16/20 mm lateral
- Spacing: 3m x 3m , 4m x 4m
- Best For: Tomato, Cucumber, Capsicum



2 Fogger / Mist System

- DropletSize: 50–70 microns
- WaterUse: 5–7 LPH per nozzle
- Pressure: 2.5–4.5 kg/cm²
- Spacing: 3m x 3m , 4m x 4m
- Best For: Nursery, Flower Crops, Seedlings



4 Micro Sprinkler

- Droplet Size: Medium spray
- WaterUse: 20–40 LPH
- Pressure: 1.5–2.5 kg/cm²
- Spacing: 3m x 3m , 4m x 4m
- Best For: Fruit Crops, Polyhouse Banana



4 Top Sprinkler System

- SprinklerType: Static
- Water Discharge: 25–50 LPH per sprinkler
- Spray Radius: 2.5 to 4 meters
- Operating Pressure: 2–3 kg/cm²

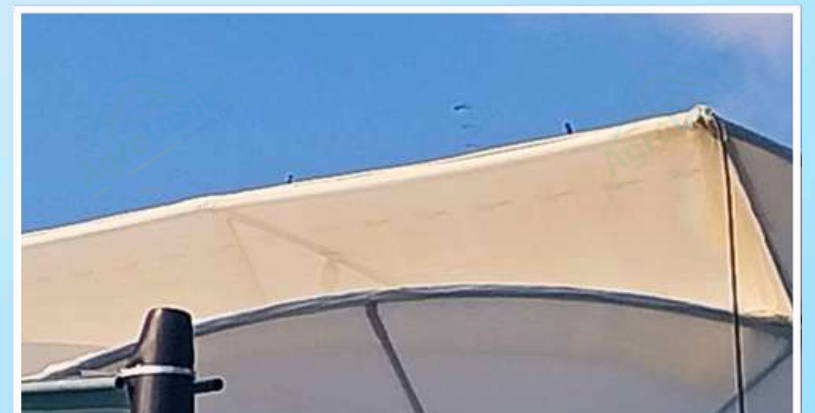

Automated Greenhouse Irrigation and Fertigation

- Enhance efficiency with smart irrigation and precise nutrient delivery systems.

IRRIGATION SYSTEM

We use high pressure drip to water all plants evenly



FERTIGATION UNIT

Delivers nutrients with high precision for optimum growth



WEATHER FORECASTING SYSTEM.

Schedule and monitor systems from one location



- A reliable solution for healthy plants, higher productivity and sustainable farming.

IRRIGATION & FERTIGATION AUTOMATION IN GREENHOUSE

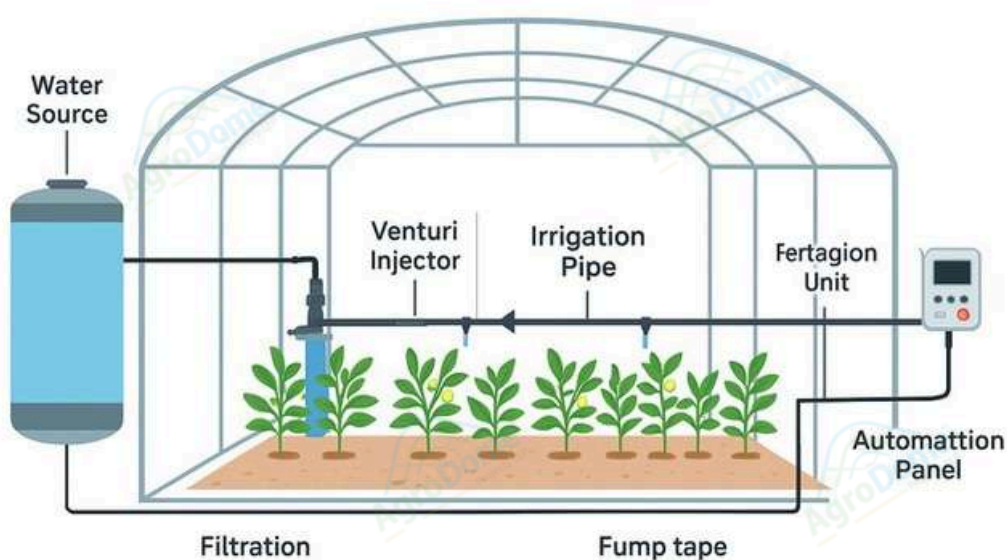

CLIMATE CONTROL AUTOMATION

- Purpose: Automatically manages temperature, humidity, CO₂, and light. How
- it works: Sensors constantly monitor the environment. If temperature or humidity goes beyond the set threshold, the controller triggers fans, heaters, or vents.

LIGHTING AUTOMATION





- Purpose: Supplement natural light when insufficient
- How it works: Lights turn on when natural light is below required levels, and turn off when light intensity is adequate.

SHADING SYSTEM AUTOMATION





- Purpose: Control sunlight penetration and internal temperature
- How it works: Curtains automatically open or close depending on sun intensity or temperature.



Benefits of Greenhouse Automation

-  Precise climate control = Better yield and plant health
-  Efficient water/nutrient use = Cost savings
-  Time saving = Less manual labor
-  Consistent crop quality
-  Higher productivity & reduced losses

Green House Accessories

 <p>Zig Zag Wire Springs (For Polyfilm or Net Locking)</p>	 <p>Poly Coated Springs</p>	 <p>Profile Varieties</p>	 <p>Greenhouse Film Repair Tape</p>	 <p>Anti Flapping Bands</p>
--	---	---	---	---

POLY/ NET FASTENING SYSTEM











 <p>Round Pipe Clamps - Full & Half</p>	 <p>5mm Single Plate- RC</p>	 <p>5mm Single Plate- SC</p>	 <p>5 way Junction Plate</p>
 <p>Square Pipe Clamps</p>	 <p>Butterfly Plate</p>	 <p>5 way Junction Plate</p>	

STRUCTURAL PIPE CONNECTORS

GUTTER /ARCH BRACKET SYSTEM





 <p>Industrial Pressed Gutter (1.50 mm to 2.50mm)</p>	 <p>Gutter End Cap</p>	 <p>Gutter Spout / Down Take</p>	 <p>Gutter Funnel</p>	 <p>Gutter Sealant Tape</p>
---	--	--	---	---

GUTTER COMPONENTS

 <p>Shade Net Oval Clip & R Hook</p>	 <p>Shade Net Joiner with Small Pulley</p>	 <p>3-U Wire Gripper Clamp</p>	 <p>Wire Support Clip</p>	 <p>Shade Net Stitching pin</p>
 <p>Steel Wire Rope Cables</p>	 <p>Wire Tightener</p>	 <p>D-Clamp</p>	 <p>Turn Buckles</p>	 <p>I-Bolt</p>

STEEL WIRE ROPE & NET HOUSE COMPONENTS

Green House Accessories

 <p>Orchard Cement Pole Clamp</p>	 <p>Orchard Round Pole Clamp</p>	 <p>Foundation Rod Clamp</p>	 <p>Orchard Pole Cap</p>
---	---	--	--

ORCHARD STRUCTURE COMPONENTS

 <p>J-Hook</p>	 <p>S-Hook</p>	 <p>5mm Single Plate- SC</p>
 <p>Stem Clip</p>	 <p>W-Hook</p>	
 <p>Twine</p>	 <p>Roller-Hook</p>	

TRELLISING ACCESSORIES

SLIDING DOORS

 <p>Curtain Clamp - UVS Plastic</p>	 <p>Curtain Clamp - Steel</p>	 <p>Anchor Rods</p>	 <p>Foundation and Extension Joint</p>	 <p>Metal Pulley Roller Bearing Inside</p>
 <p>Plastic Pulley Roller Bearing Inside</p>	 <p>UVS Ropes</p>	 <p>Self Drilling Screws</p>	 <p>Nut Bolts (Hot Dip Galvanised)</p>	 <p>Polyester Wire</p>

OTHER ACCESSORIES

 <p>Curtain Roll Up Gear Handle</p>	 <p>Curtain Rollup Unit (Chain Pulley)</p>	 <p>Universal Joint (HD Gal, Solid Bar Union)</p>
---	---	---

SIDE SCREEN / VENTS OPERATORS

Green House Accessories



Blades Diameter (mm/ inches)	Air Flow (CMH)	Noice Deci bel s	I mpor t Power (W)	Rated Voltage (V)	Body Height (mm)	Body Width (mm)	Body Length (mm)
500 / 20	18,000	≤70	370	380/ 220	600	600	320
750 / 30	22,000	≤70	370	380/ 220	900	900	400
900 / 36	25,000	≤70	550	380/ 220	1000	1000	400
1250 / 50	44,000	≤70	1100	380/ 220	1380	1380	400

Power:1 Phase / 3 Phase

HVAC/ EXHAUST FANS

Cellulose Evaporative Colling Pads

Material :Cra Paper95GSM - 105GSM :100mm /
Thickness 150mm

Size :1200 x 600mm / 1500 x 600mm /
1800 x 600mm / 2000 x 600mm

Flute Size :7090, 5090

Evaporative Cooling Pad Frames

Thickness Width :100mm / 150mm :2000 /
Height 4000mm :1200 / 1500 / 1800 /
2000mm

Aluminum Frame :100mm = 1.20mm /
150mm = 1.50mm



COOLING PADS



Material : SS Body, 7 Aluminum Blades
Thickness Voltage : 1.2mm
Frequency : 220v / Single Phase
Motor Power Air : 50 / 60hz
Flow Blade Speed : 350w
Air Flow : 16900 CFM
Throughput : 1440 RPM
Size Power : 18-22 meter
: 570 x 570 x 400mm
: 1 Phase / 3 Phase

AIR CIRCULATION FANS

Green House Accessories



Power : 2.5 KW
Type : Finned Tube Heater35-wa
High - Speed Fan : 2800 RPM
Coverage : ~80 m3
Dimension : H320 mm x L440 mm x W320 mm x 10kg

HEATING FAN

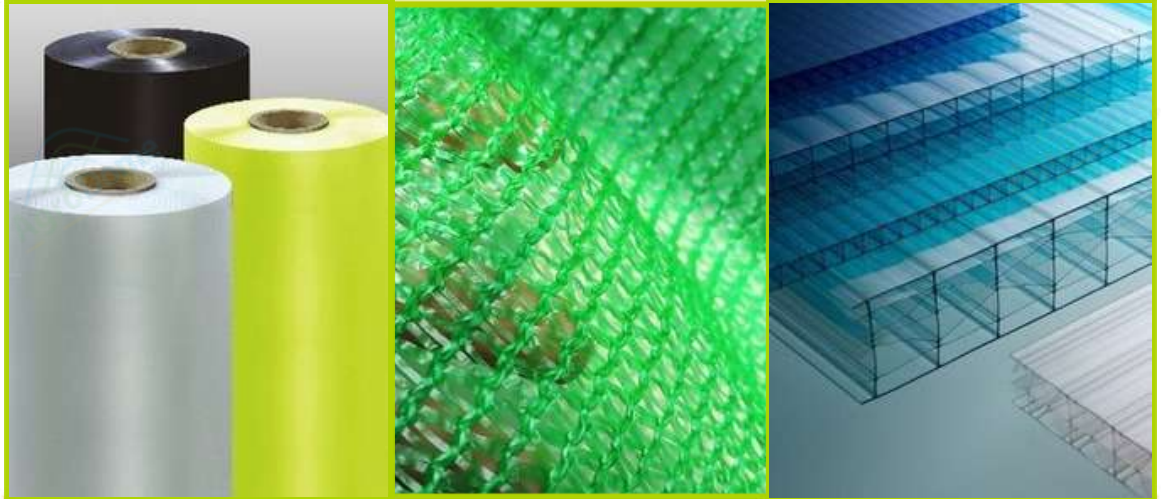

UVS FILMS / NETS / POLYCARBONATE SHEETS

5mm Single Plate- SC

Side Screen / Roof Screen Roll Up Motor



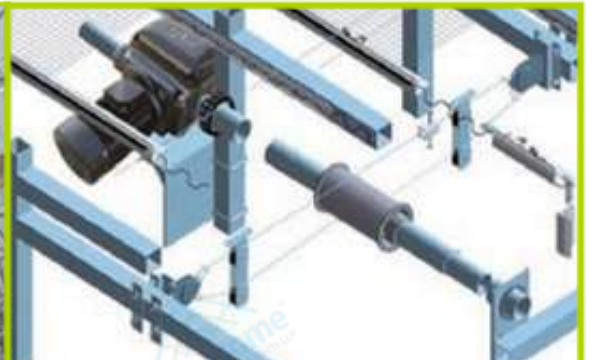

Rack & Pinion Screen System **Screen Automation** **Cable & Pulley Motorized**
SHADING/ ENERGY SCREEN MOTORIZED



Temperature & Humidity Sensors **Weather Station**
CUSTOMIZATION AS PER PROJECT



AgroDomeTM
Projects LLP

+91 9898173376
+91 9825332949

471,4th Floor ,Suyas Solitaire
Near Podar International School ,
Kudasan , Gandhinagar ,Gujarat - 382424 ,(INDIA)

info@agrodome.in
www.agrodome.in



Scan me
for
Website



Scan me
for
WhatsApp